

**INDEX OF DOCUMENTS HELD ON THE PUBLIC REGISTER FOR
GEOTHERMAL EXPLORATION LICENCE GEL 258**

- | | | |
|----|----------------|--|
| 1. | 22 March 2007 | Memorandum entering GEL 258 on the public register. |
| 2. | 22 March 2007 | Geothermal Exploration Licence GEL 258 |
| | | Interests: Granite Power Limited 100% |
| 3. | 29 March 2007 | Gazettal of Grant of GEL 258 |
| 4. | 10 August 2007 | Memorandum entering surrender of GEL 258 on the public register. |
| 5. | 10 August 2007 | Surrender of Geothermal Exploration Licence GEL 258 |
| 6. | 16 August 2007 | Gazettal of Surrender of Licence |

PETROLEUM ACT 2000

Surrender of Geothermal Exploration Licences—GELs 251, 252, 256, 257, 258 and 259

NOTICE is hereby given that I have accepted the surrender of the abovementioned Geothermal Exploration Licences under the provisions of the Petroleum Act 2000, pursuant to delegated powers dated 28 March 2002, *Gazetted* 11 April 2002, page 1573.

No. of Licence	Licensees	Date of Surrender	Area in km ²	Reference
251	Granite Power Limited	10 July 2007	479	27/2/410
252	Granite Power Limited	10 July 2007	452	27/2/411
256	Granite Power Limited	10 July 2007	452	27/2/414
257	Granite Power Limited	10 July 2007	451	27/2/415
258	Granite Power Limited	10 July 2007	491	27/2/416
259	Granite Power Limited	10 July 2007	489	27/2/417

Description of Area—GEL 251

All that part of the State of South Australia, bounded as follows:

Commencing at a point being the intersection of latitude 29°42'00"S GDA94 and longitude 135°33'00"E GDA94, thence east to longitude 135°56'00"E GDA94, south to latitude 29°49'00"S GDA94, west to longitude 135°33'00"E GDA94 and north to the point of commencement.

Area: 479 m² approximately.

Description of Area—GEL 252

All that part of the State of South Australia, bounded as follows:

Commencing at a point being the intersection of latitude 29°49'00"S GDA94 and longitude 135°38'00"E GDA94, thence east to longitude 135°45'00"E GDA94, south to latitude 30°01'00"S GDA94, west to longitude 135°32'00"E GDA94, north to latitude 29°55'00"S GDA94, west to longitude 135°30'00"E GDA94, north to latitude 29°51'00"S GDA94, east to longitude 135°38'00"E GDA94 and north to the point of commencement.

Area: 452 m² approximately.

Description of Area—GEL 256

All that part of the State of South Australia, bounded as follows:

Commencing at a point being the intersection of latitude 28°18'00"S GDA94 and longitude 133°54'00"E GDA94, thence east to longitude 134°04'00"E GDA94, south to latitude 28°33'00"S GDA94, west to longitude 133°54'00"E GDA94 and north to the point of commencement.

Area: 452 m² approximately.

Description of Area—GEL 257

All that part of the State of South Australia, bounded as follows:

Commencing at a point being the intersection of latitude 28°30'00"S GDA94 and longitude 135°28'00"E GDA94, thence east to longitude 135°38'00"E GDA94, south to latitude 28°45'00"S GDA94, west to longitude 135°28'00"E GDA94 and north to the point of commencement.

Area: 451 m² approximately.

Description of Area—GEL 258

All that part of the State of South Australia, bounded as follows:

Commencing at a point being the intersection of latitude 29°28'20"S GDA94 and longitude 134°30'00"E GDA94, thence east to longitude 134°43'00"E GDA94, south to latitude 29°35'00"S GDA94, east to longitude 134°47'00"E GDA94, south to latitude 29°41'00"S GDA94, west to longitude 134°34'00"E GDA94, north to latitude 29°35'00"S GDA94, west to longitude 134°30'00"E GDA94 and north to the point of commencement.

Area: 491 m² approximately.

Description of Area—GEL 259

All that part of the State of South Australia, bounded as follows:

Commencing at a point being the intersection of latitude 28°28'53"S GDA94 and longitude 133°30'53"E GDA94, thence east to longitude 133°42'07"E GDA94, south to latitude 28°43'21"S GDA94, west to longitude 133°30'53"E GDA94 and north to the point of commencement.

Area: 489 m² approximately.

Dated 10 August 2007.

C. D. COCKSHELL,
Acting Director Petroleum and Geothermal
Minerals and Energy Resources
Primary Industries and Resources SA
Delegate of the Minister for Mineral Resources Development

Petroleum Act 2000

SURRENDER OF GEOTHERMAL EXPLORATION LICENCES

GELs 251, 252, 256, 257, 258 and 259

I, CYRIL DAVID COCKSHELL, Acting Director Petroleum and Geothermal, Minerals and Energy Resources, Department of Primary Industries and Resources, in the State of South Australia, pursuant to the provisions of section 89(2) of the *Petroleum Act 2000* and all other enabling powers, for and on behalf of Paul Holloway, Minister for Mineral Resources Development (Minister), pursuant to delegated powers dated 28 March 2002, Gazetted 11 April 2002, page 1573 –

- (a) hereby accept the surrender of Geothermal Exploration Licences – GELs 251, 252, 256, 257, 258 and 259, in the name of Granite Power Limited, with effect from and including 10 August 2007.

Dated: 10 August 2007

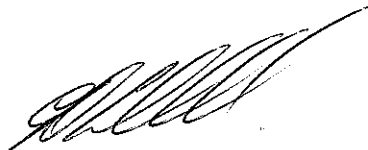

**C. D. COCKSHELL
A/Director Petroleum and Geothermal
Minerals and Energy Resources
Primary Industries and Resources SA
Delegate of the Minister for Mineral Resources
Development**

Petroleum Act 2000
S.115

MEMORANDUM

GEOHERMAL EXPLORATION LICENCES
GELs 251, 252, 256, 257, 258 and 259

1. Surrender of the above-mentioned Geothermal Exploration Licences, with effect from 10 August 2007 is hereby entered on the public register.

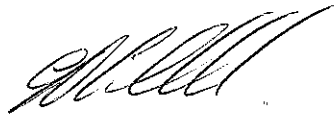

C. D. COCKSHELL
A/Director Petroleum and Geothermal
Minerals and Energy Resources
Primary Industries and Resources SA
Delegate of the Minister for Mineral Resources
Development

Date: 10 August 2007

Ref: 27/2/410
27/2/411
27/2/414
27/2/415
27/2/416
27/2/417

PETROLEUM ACT 2000

Grant of Geothermal Exploration Licences—GEL 256, GEL 257, GEL 258 and GEL 259

NOTICE is hereby given that the undermentioned Geothermal Exploration Licences have been granted under the provisions of the Petroleum Act 2000, pursuant to delegated powers dated 28 March 2002, *Gazetted* 11 April 2002, page 1573.

No. of Licence	Licensee	Locality	Expiry
GEL 256	Granite Power Limited	Arckaringa Basin	21 March 2012
GEL 257	Granite Power Limited	Arckaringa Basin	21 March 2012
GEL 258	Granite Power Limited	Arckaringa Basin	21 March 2012
GEL 259	Granite Power Limited	Arckaringa Basin	21 March 2012

Description of Area—GEL 256

All that part of the State of South Australia, bounded as follows:

Commencing at a point being the intersection of latitude 28°18'00"S GDA94 and longitude 133°54'00"E GDA94, thence east to longitude 134°04'00"E GDA94, south to latitude 28°33'00"S GDA94, west to longitude 133°54'00"E GDA94 and north to the point of commencement.

Area: 452 km² approximately.

Description of Area—GEL 257

All that part of the State of South Australia, bounded as follows:

Commencing at a point being the intersection of latitude 28°30'00"S GDA94 and longitude 135°28'00"E GDA94, thence east to longitude 135°38'00"E GDA94, south to latitude 28°45'00"S GDA94, west to longitude 135°28'00"E GDA94 and north to the point of commencement.

Area: 451 km² approximately.

Description of Area—GEL 258

All that part of the State of South Australia, bounded as follows:

Commencing at a point being the intersection of latitude 29°28'20"S GDA94 and longitude 134°30'00"E GDA94, thence east to longitude 134°43'00"E GDA94, south to latitude 29°35'00"S GDA94, east to longitude 134°47'00"E GDA94, south to latitude 29°41'00"S GDA94, west to longitude 134°34'00"E GDA94, north to latitude 29°35'00"S GDA94, west to longitude 134°30'00"E GDA94 and north to the point of commencement.

Area: 491 km² approximately.

Description of Area—GEL 259

All that part of the State of South Australia, bounded as follows:

Commencing at a point being the intersection of latitude 28°28'53"S GDA94 and longitude 133°30'53"E GDA94, thence east to longitude 133°42'07"E GDA94, south to latitude 28°43'21"S GDA94, west to longitude 133°30'53"E GDA94 and north to the point of commencement.

Area: 489 km² approximately.

Dated 22 March 2007.

C. D. COCKSHELL, Acting Director Petroleum and Geothermal
Minerals and Energy Resources
Primary Industries and Resources SA
Delegate of the Minister for Mineral Resources Development

**Petroleum Act 2000
S.115**

MEMORANDUM

**GEOHERMAL EXPLORATION LICENCES
GEL 256, 257, 258 AND GEL 259**

1. This Licence granted on 22 March 2007 is hereby entered on the public register.
2. Interests in the licence are:-

Granite Power Limited

100%



**C.D. COCKSHELL
A/Director Petroleum and Geothermal
Minerals and Energy Resources
Primary Industries and Resources SA
Delegate of the Minister for Mineral Resources
Development**

Date: 22 March 2007

Ref: 27/2/414
27/2/415
27/2/416
27/2/417

PETROLEUM ACT 2000

GEOHERMAL EXPLORATION LICENCE

GEL 258

I, BARRY ALAN GOLDSTEIN, Director Petroleum and Geothermal, Minerals and Energy Resources, Primary Industries and Resources, in the State of South Australia pursuant to the provisions of the *Petroleum Act 2000* and all other enabling powers, for and on behalf of Paul Holloway, Minister for Mineral Resources Development (Minister), pursuant to delegation dated 28 March 2002, (refer Government Gazette dated 11 April 2002 page 1573), HEREBY GRANT to:

Granite Power Limited ACN 112 714 440

(hereinafter referred to as the Licensee) an Exploration Licence in relation to a source of geothermal energy in respect of the area set out below, to have effect for a period of five years and to expire on 21 MARCH 2012 but carrying the right of renewal under the *Petroleum Act 2000*.

DESCRIPTION OF AREA

The land comprised in this licence is that part of the State of South Australia described in the Schedule hereto:

CONDITIONS

1. During the term of the licence, the Licensee shall carry out or cause to be carried out, exploratory operations on the area comprised in the licence in accordance with such work programs as are approved by the Minister from time to time. Year one exploratory operations are guaranteed, and any subsequent licence year work program becomes guaranteed upon entry into any such licence year. These exploratory operations shall include but not necessarily be limited to:-

Year of Term of Licence	Minimum Work Requirements
One	<ul style="list-style-type: none">• Geological and geophysical studies.
Two	<ul style="list-style-type: none">• Geological and geophysical studies.• Deepening of existing stratigraphic hole to 1000 metres.
Three	<ul style="list-style-type: none">• Conduct down-hole seismic induction probes, cross-well tomography, and gamma, resistivity and temperature logging.• Test the temperature gradient in one existing deep drill hole.
Four	<ul style="list-style-type: none">• Drill one pilot hole to 2000 metres.• Construct pilot plant.
Five	<ul style="list-style-type: none">• Construction of a 25MW pilot power station.

2. The Licensee must take all reasonable precautions to minimise the risks of its activities resulting in a significant loss of petroleum reserves or a significant reduction in the recovery of petroleum reserves.
3. The Licensee must:
 - (a) upon commencement of regulated activities under this licence, maintain in force during the term of this licence public liability insurance to cover regulated activities under this licence (including sudden and accidental pollution) in the name of the Licensee for a sum not less than twenty million dollars (\$20,000,000.00) or such greater sum as specified by the Minister and make such amendments to the terms and conditions of the insurance as the Minister may from time to time require;
 - (b) maintain in force during the drilling of any well or operation in any well, control of well insurance in the name of the Licensee for a sum not less than ten million dollars (\$10,000,000.00) or such greater sum as specified by the Minister and make such amendments to the terms and conditions of the insurance as the Minister may from time to time require;
 - (c) upon request by the Minister, provide the Minister with a cover note or certificate of currency of each insurance policy referred to in paragraphs (a) and (b).
4. The Minister in specifying the levels of insurance accepts no liability for the completeness of their listing, the adequacy of the sum insured, the limit of liability, the scoped coverage, the conditions or exclusions of these insurances in respect to how they may or may not respond to any loss, damage or liability.
5. The Licensee will ensure, when preparing an Environmental Impact Report under Part 12 of the *Petroleum Act 2000*, that the report also includes an assessment of the potential economic consequences for other licensees under the *Petroleum Act 2000* or *Mining Act 1971* and owners of land, arising out of proposed regulated activities to be carried out in the licence area.
6. The Licensee must keep confidential any measurements made in a well which would enable the estimation of petroleum reserves ("Confidential Information") and must not disclose the Confidential Information without first obtaining the written consent of the licensee of the overlapping compatible licence, unless:
 - (a) it is a disclosure required under the Act, this licence or any other law;
 - (b) it is a disclosure which is for the purposes of prosecuting or defending any legal proceedings; or
 - (c) it is information which is or becomes public knowledge other than by breach of this licence condition.
7. A contract or agreement entered into by the licensee to transfer or accept liability for any well or facility constructed for the purpose of undertaking a regulated activity under the *Petroleum Act 1940* or *2000* cannot transfer, limit or exclude liability under the *Petroleum Act 2000* unless written consent of the Minister is obtained.
8. In the event that the Licensee during any year of the term of this licence (a year being the period of twelve calendar months ending on the anniversary of the date upon which the licence comes into force) fails to comply with the work program requirements of this licence, it is an express term of this licence that the Minister then may use discretion to either cancel this licence or authorise such variation to these requirements as the Minister thinks fit.

9. The Licensee shall during periods determined by the Minister, lodge and maintain with the Minister, for the satisfaction of obligations arising under the Act or this licence, a security of \$50,000 (fifty thousand dollars) or such greater sum as specified by the Minister from time to time.

("the Security").

- 9.1 The Security shall be lodged in the form of either;
- (a) cash; or
 - (b) an unconditional, irrevocable bank guarantee or letter of credit in a form, and from a financial institution, approved by the Minister,
- 9.2 Interest will not be payable by the Minister to the Licensee on any cash Security.
- 9.3 All charges incurred by the Licensee in obtaining and maintaining the Security, shall be met by the Licensee.
- 9.4 If upon expiry, this Licence is not renewed and the Minister is satisfied that there are no further obligations under this Licence or the Act, the Minister will return the Security to the Licensee.

Date:.....22 MARCH.....2007

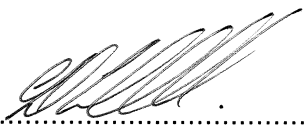
for
BARRY A. GOLDSTEIN
Director Petroleum and Geothermal
Minerals and Energy Resources
Primary Industries and Resources SA
Delegate of the Minister for Mineral Resources Development

Signed by the said LICENSEE

Date: 8/3/07.....2007

.....
Authorised Representative

STEPHEN DE BRU
.....
Name

MANAGING DIRECTOR
.....
Position

GRANITE POWER LIMITED
.....
Company formerly PTD

.....
Witness

DANIELA VECCHIO
.....
Name

OFFICE MANAGER
.....
Position

GRANITE POWER LIMITED
.....
Company FORMERLY PTD

GEOHERMAL EXPLORATION LICENCE

GEL 258

THE SCHEDULE

Description of Area

All that part of the State of South Australia, bounded as follows:-

Commencing at a point being the intersection of latitude 29°28'20"S GDA94 and longitude 134°30'00"E GDA94, thence east to longitude 134°43'00"E GDA94, south to latitude 29°35'00"S GDA94, east to longitude 134°47'00"E GDA94, south to latitude 29°41'00"S GDA94, west to longitude 134°34'00"E GDA94, north to latitude 29°35'00"S GDA94, west to longitude 134°30'00"E GDA94, and north to the point of commencement.

AREA: **491** square kilometres approximately.

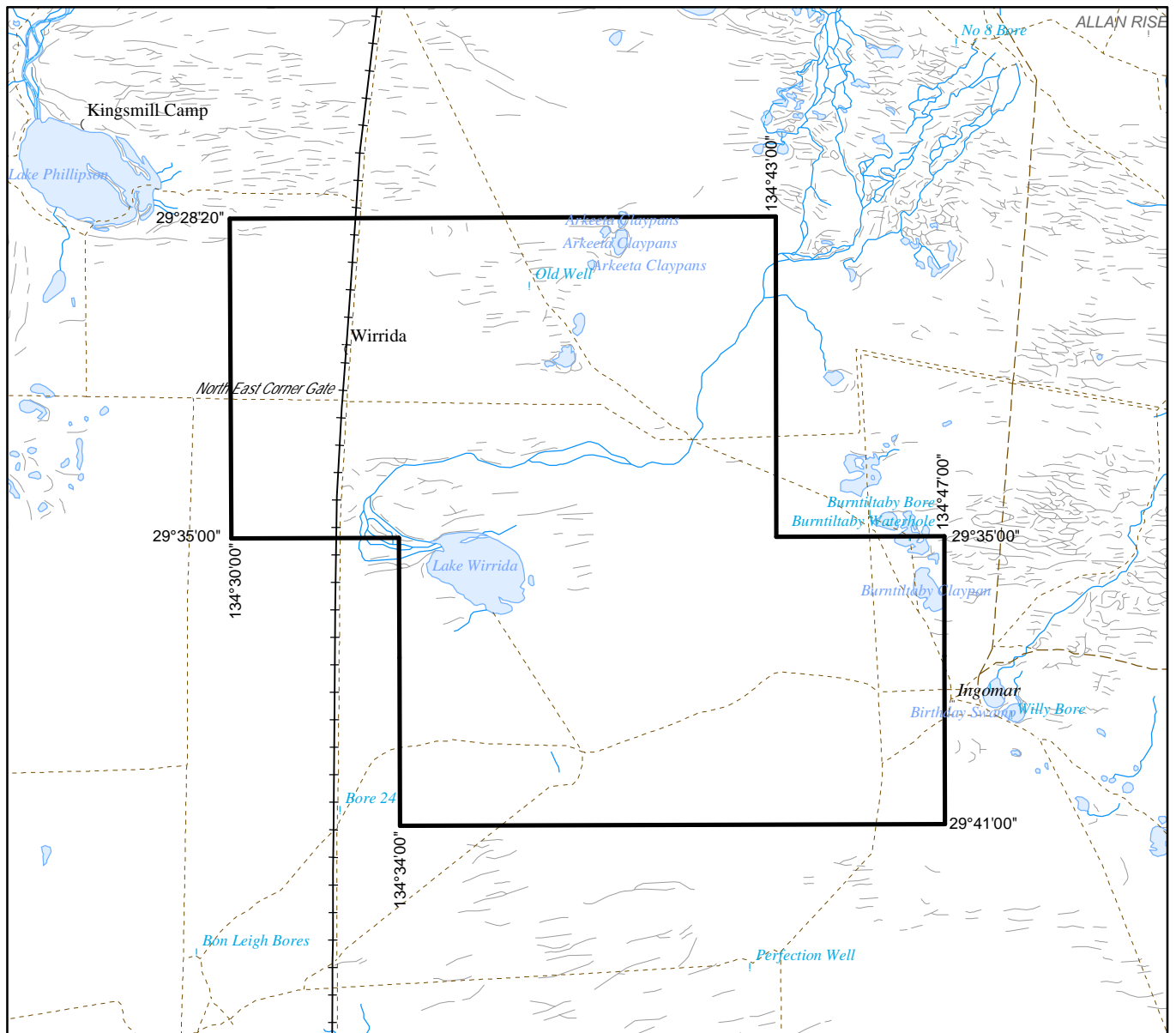

SCALE 1:250 000

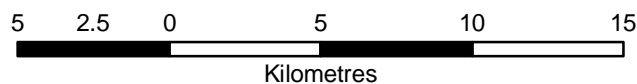

Note: There is no warranty that the boundary of this licence is correct in relation to other features of the map. The boundary is to be ascertained by reference to the Geocentric Datum of Australia (GDA94) and the schedule.

THE PLAN HEREINBEFORE REFERRED TO

GEOTHERMAL EXPLORATION LICENCE NO: 258



Government of South Australia
Primary Industries and Resources SA

SR 27/2/416

AREA: 491 sq km (approx)